

Intrusive Investigations

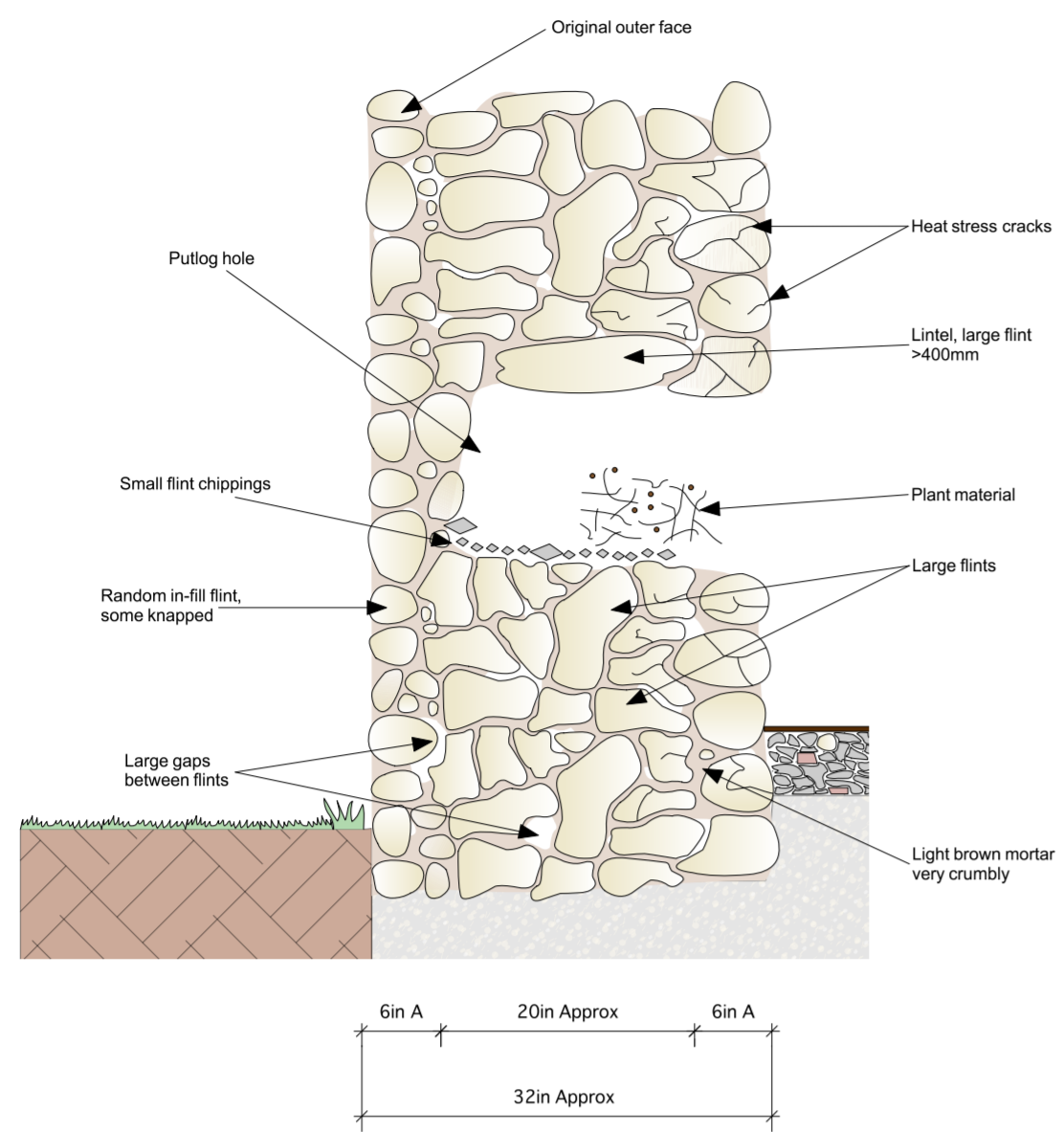

- General Notes
- Random arrangement of flints, all different sizes
 - Some loose, some rigid
 - The mortar is mainly light brown, very crumply and flaky
 - Some flints are cracked and fall apart very easily
 - Large gaps between some of the flints
 - Small flint chippings in the trial hole, primarily flaking off the flints above

Section AA

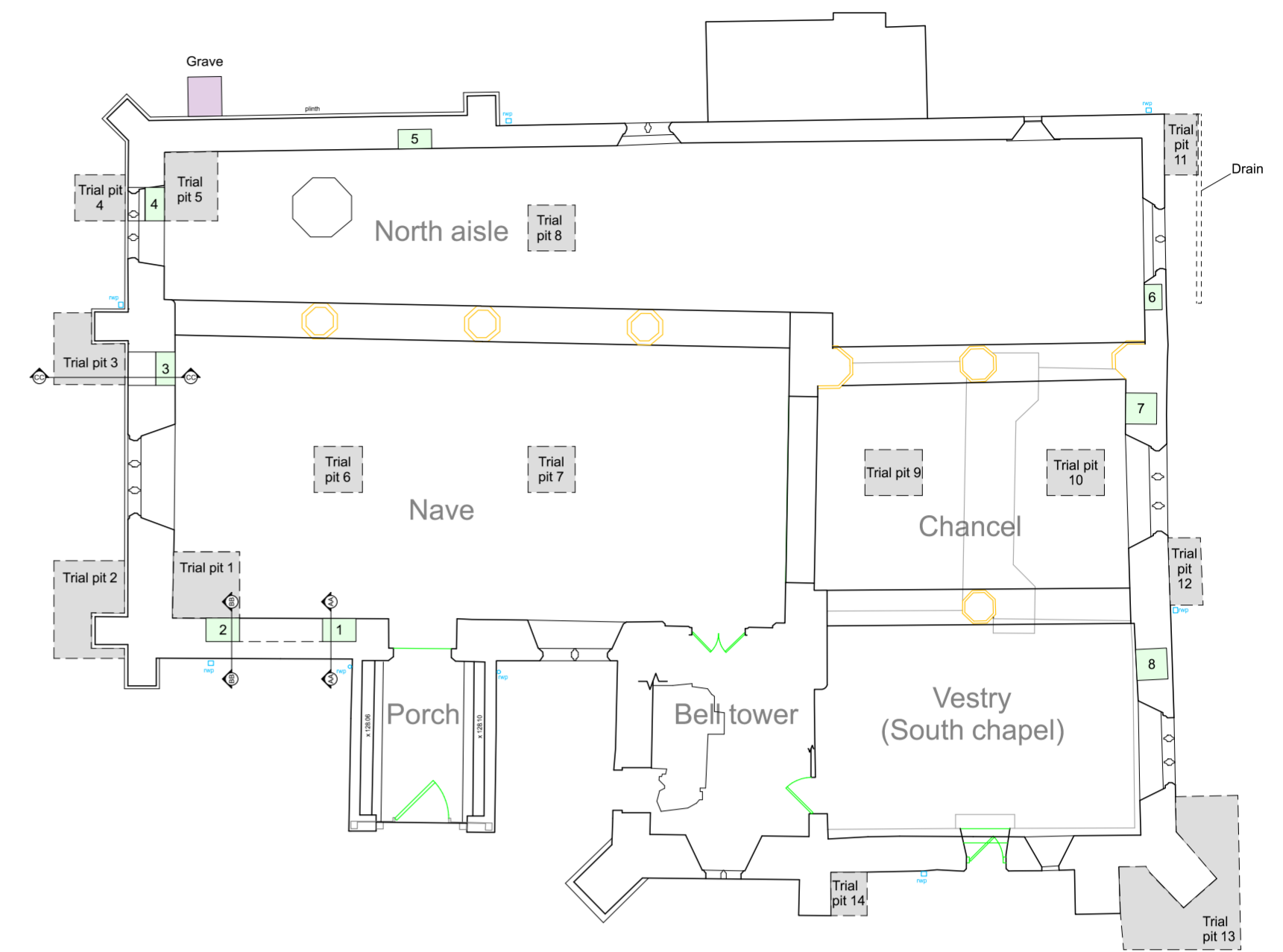

Plan of Intrusive Investigations

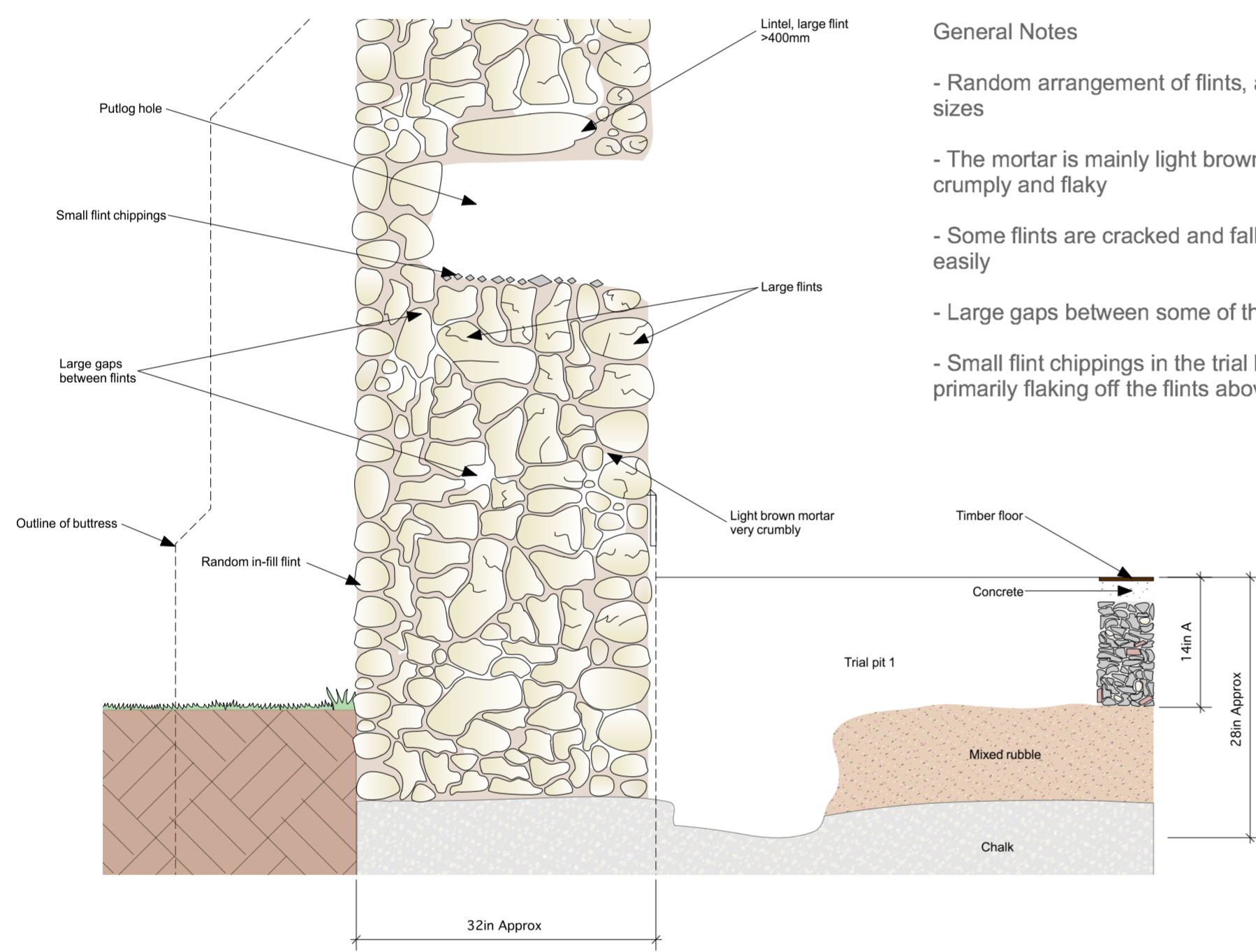

- General Notes
- Random arrangement of flints, all different sizes
 - The mortar is mainly light brown, very crumply and flaky
 - Some flints are cracked and fall apart very easily
 - Large gaps between some of the flints
 - Small flint chippings in the trial hole, primarily flaking off the flints above

Section BB

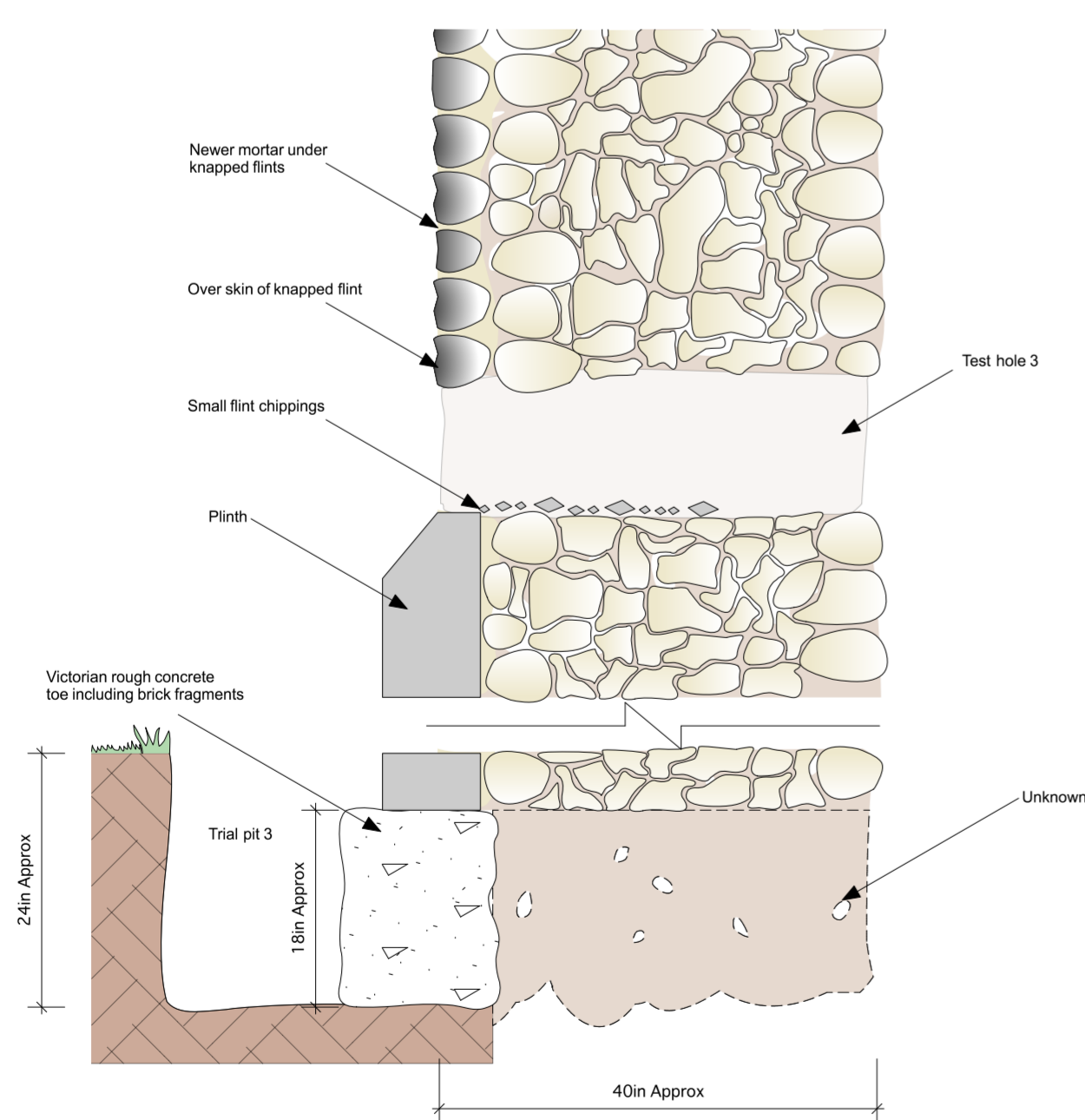

- General Notes
- Random arrangement of flints, all different sizes
 - The mortar is mainly light brown, very crumply and flaky
 - Some flints are cracked and fall apart very easily
 - Small flint chippings in the trial hole, primarily flaking off the flints above
 - Outer skin of knapped flint added at a later date
 - Victorian foundation under over skinned area of the wall, unknown what the older part of the wall is built on

Section CC



Images of Intrusive Investigations